

Step motor Encoder Specification			
<b>Model</b>	<b>MS28H-ER</b>	<b>Editor</b>	<b>SR, Lee</b>
<b>Number</b>	<b>RMN-02500-28H-N5-10</b>	<b>Date</b>	<b>2025-3-2</b>

### 1. Encoder Spec.

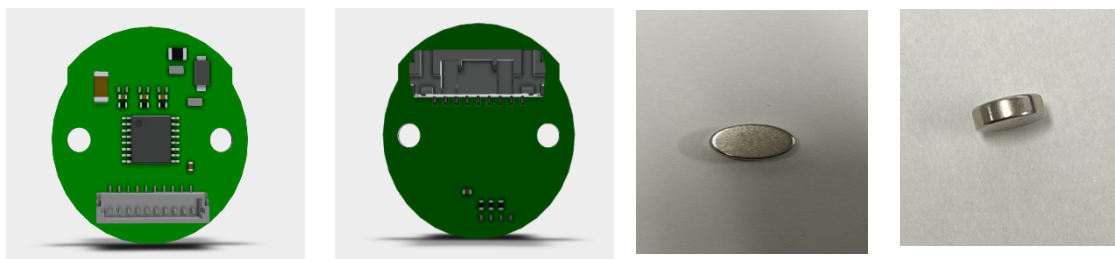

Type		Specification
Sensor Board	Sensor Type	Magnetic Angle Encoder
	Resolution	2,500PPR~ (Resolution Changeable)
	Connector	9pin connector(ABZ+F.G), 10pin connector(SPI)
	Type	Incremental (9pin)+F.G
	Size	PCB : $\Phi 24$
	I/O	ABZ differential
	Power	3.3V
Magnet	Polarity	2-pole Magnet s
	Size	6pi (Height : 2mm)

## 2. Pin-map

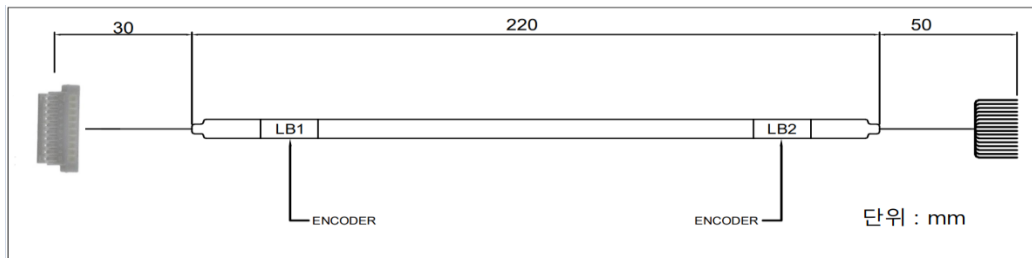

No	Name	Color
1	VDD	Orange
2	GND	Blue
3	A	Yellow
4	A+	Gray
5	B	Purple
6	B+	White
7	Z	Red
8	Z+	Green
9	F.G	Mesh line -

- Connector : 5023860970/(MOLEX)
- Cable : 502380900 (9pin / 1.25mm pitch / 26AWG)
- 

## 3. Dimension

### 5-1) PCB

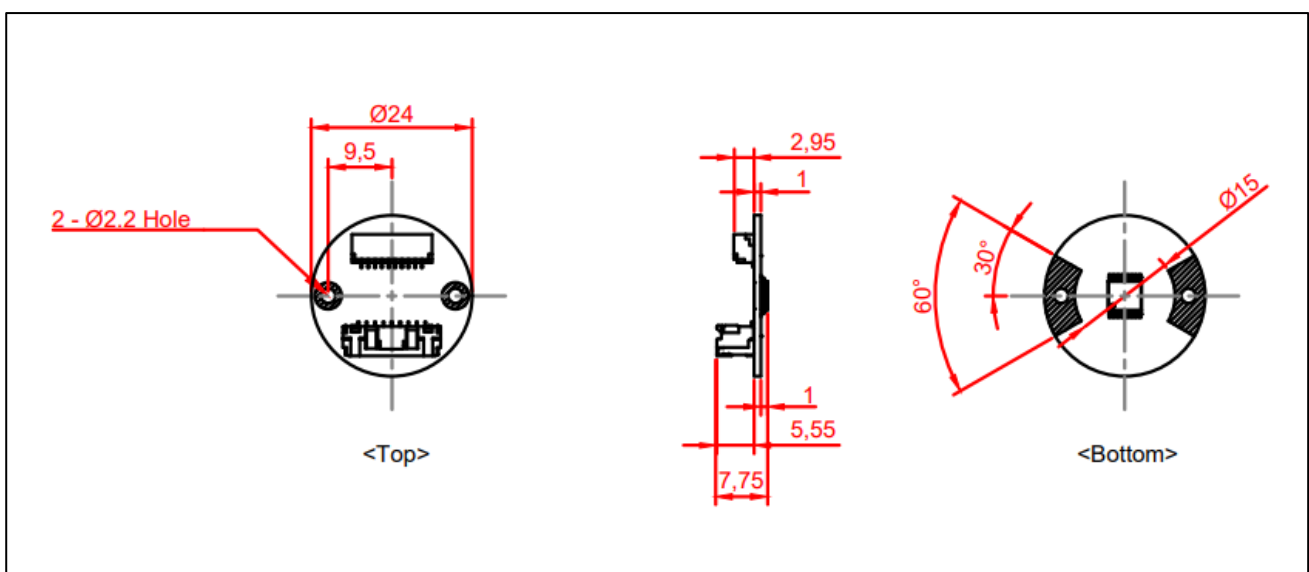

### 5-2) Magnet

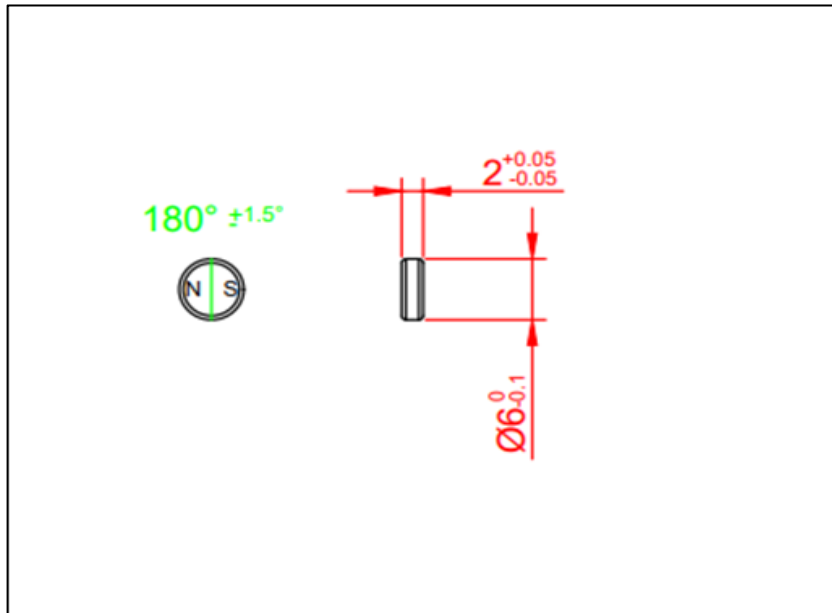

### 5-3) Magnet Bracket (6\*5PI, 6PI)

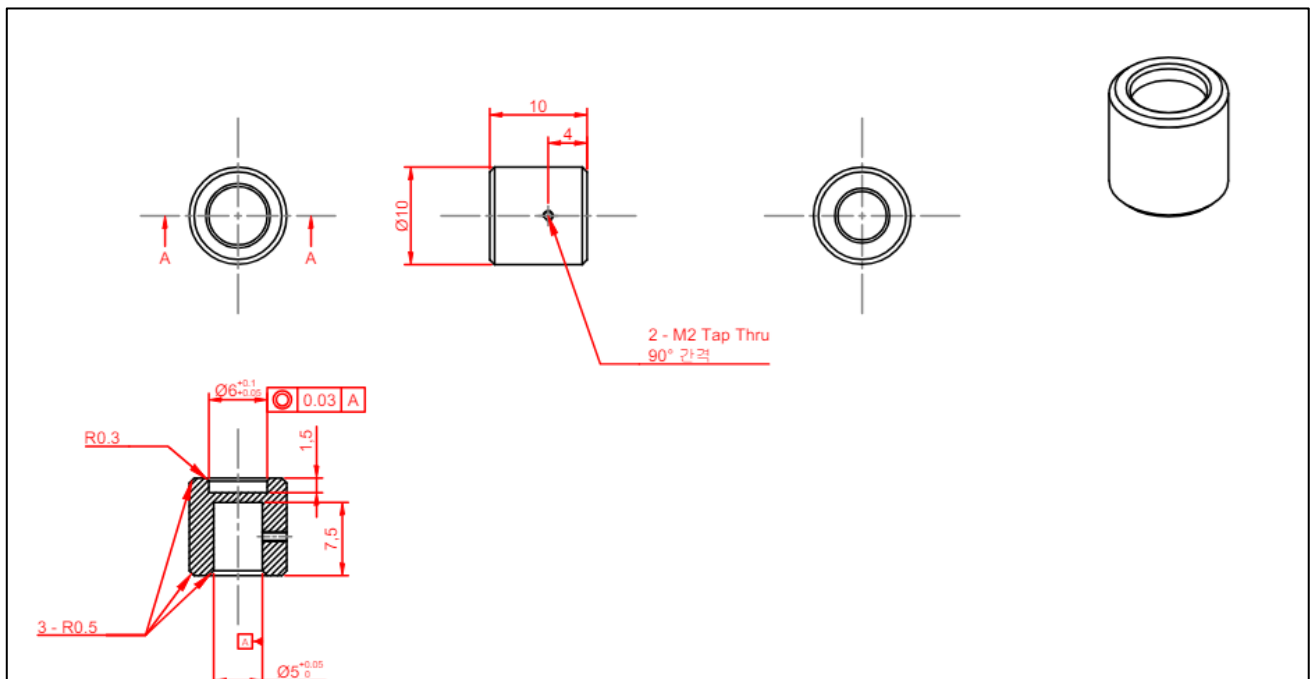

- Magnet Bracket 5Φ

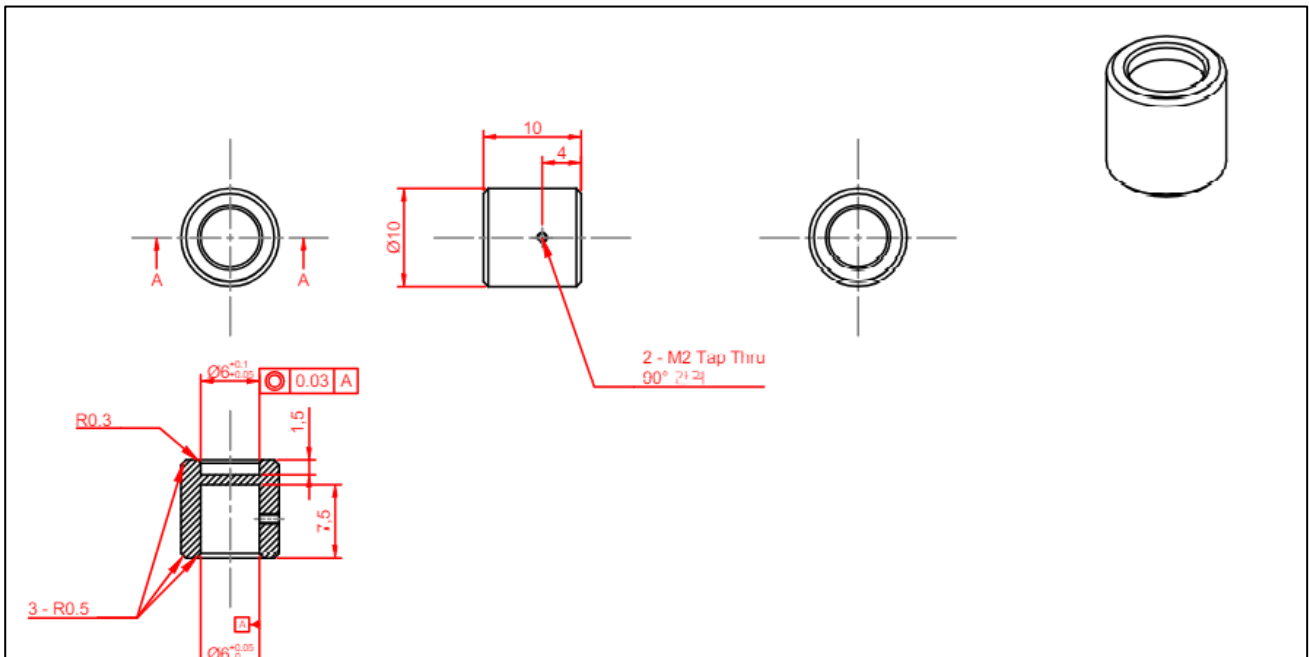

- Magnet Bracket 6Φ

#### 4. Delivery list

No	Name	Quantity
1	PCB	1ea
2	Magnet	1ea
3	Magnet Bracket	1ea

#### 5. Option

No	Name	Quantity
1	Calibration Tool	1ea
2	Cable	1ea
3	Magnet Bracket	1ea

## 6. Naming Rules

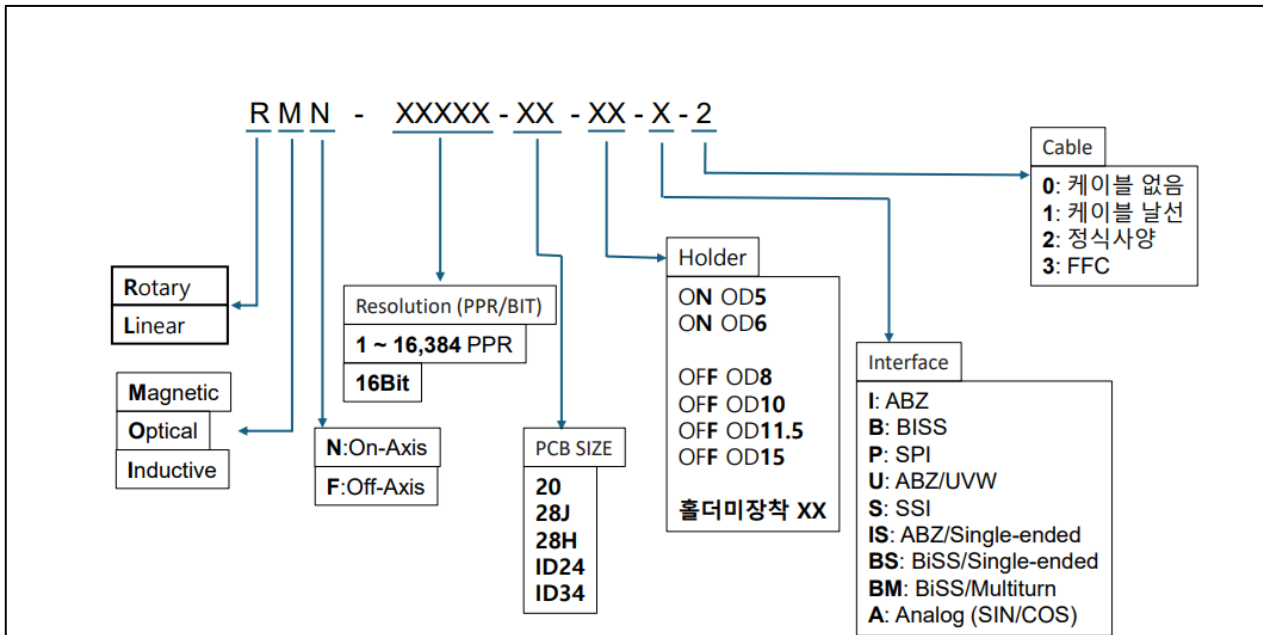

## 7. History

Version	Date	History
Rev 1.0	2025.3.2	Initial release